

SALES DRAWING SALES DRAWING SALES DRAWING SALES DRAWING SALES DRAWING

SALES DRAWING SALES DRAWING SALES DRAWING SALES DRAWING SALES DRAWING

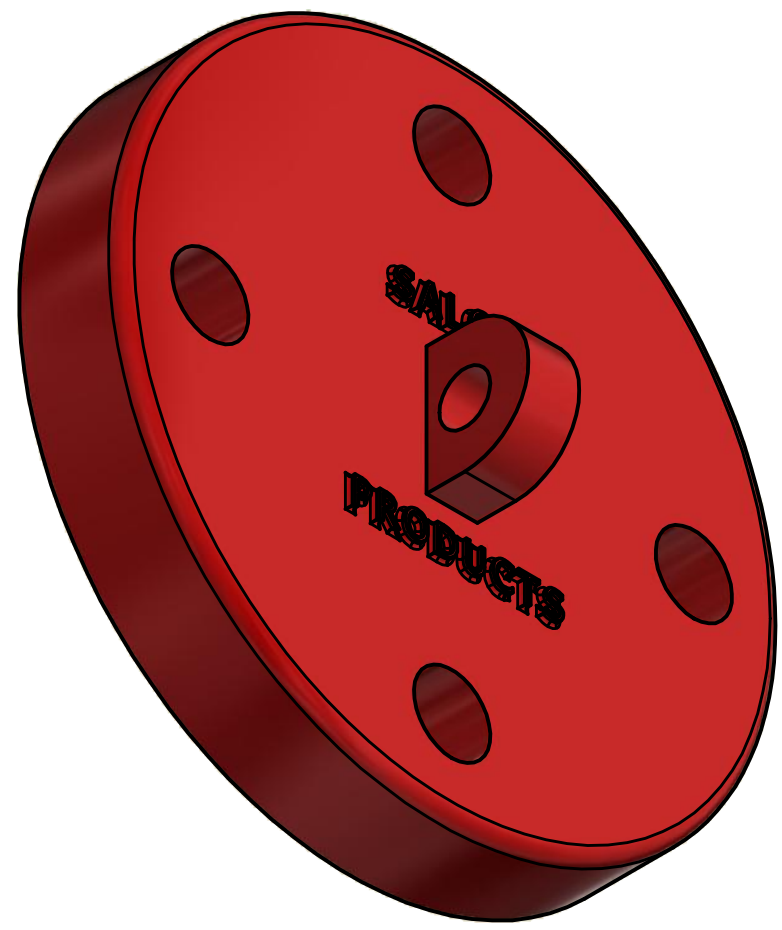
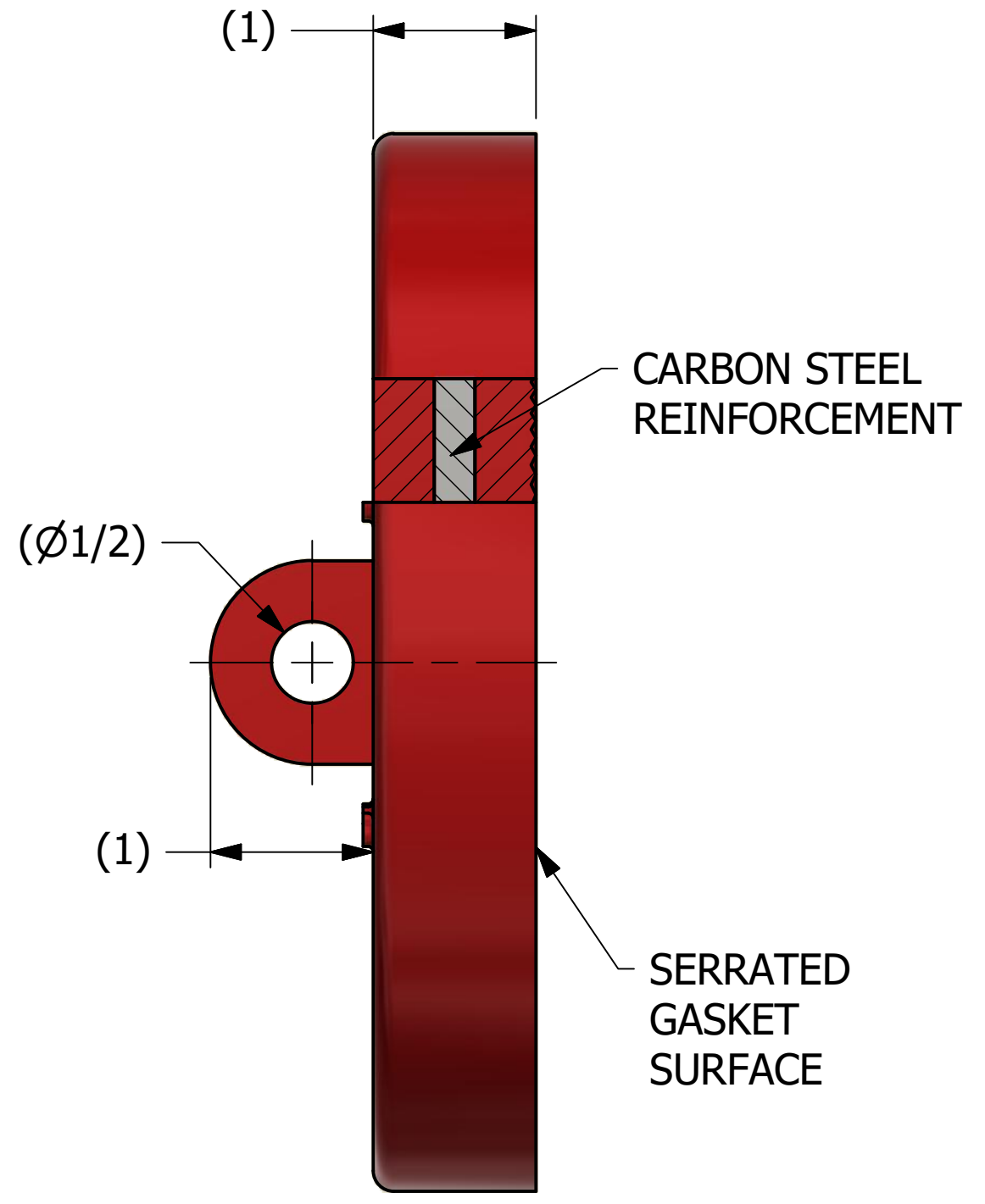
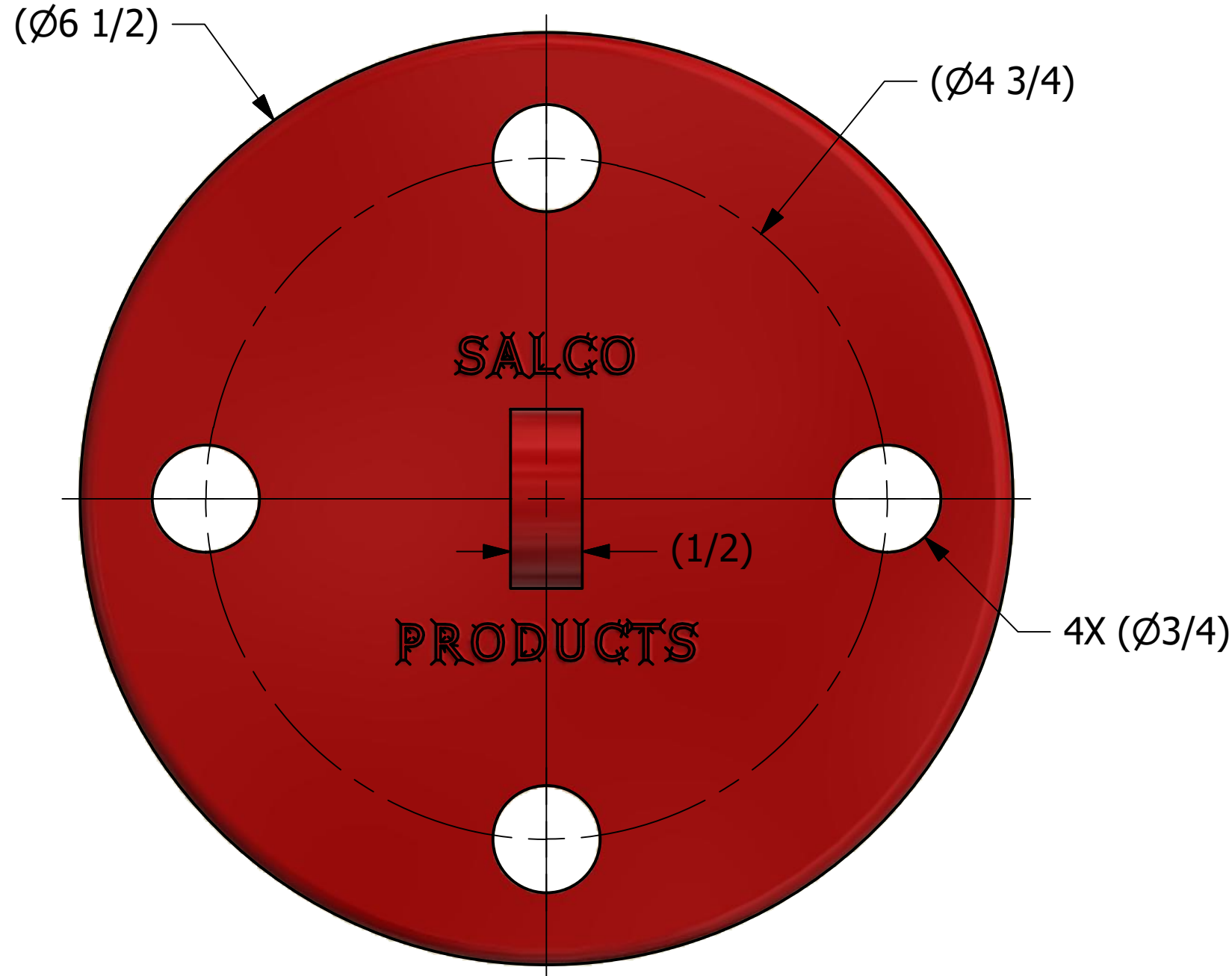

ISOMETRIC VIEW

UNLESS OTHERWISE SPECIFIED DIMENSIONAL TOLERANCES FRACTIONAL: ±1/16 X.XX: ±.03 X.XXX: ±.015 ANGLE: ±1° DEBURR ALL SHARP EDGES. ALL MACHINED SURFACES TO HAVE A 125 RMS FINISH UNLESS NOTED OTHERWISE. THIRD ANGLE PROJECTION	DRAWN BY:	WEB
	CHECKED BY:	JRO
	PROTOTYPE DATE:	11/4/2013
	APPROVED FOR PRODUCTION BY:	WEB
	PRODUCTION DATE:	12/2/2014
	SIZE:	C
	DRAWING #:	37660

D	CHL	10/14/20	202010140736	CHL
REV	BY	DATE	REF #	PUB
SALCO PRODUCTS, INC.				
PART NAME: REINFORCED BLIND FLANGE 2"				
MATERIAL: UHMWPE-COATED CARBON STEEL				
PROJECT #: 131001T		SHEET #: 1 OF 1		SCALE: 1:1
PART #: HS2150BFRPE				